

# LIQUIfit™ VAS

## Angled Stop Valve



The LIQUIfit angle stop adapter valve is designed to allow users to quickly add a connection between an angle stop valve and a riser when installing water filtration equipment, coffee brewers or ice makers into a plumbing system. A tough engineered thermoplastic material minimizes the potential for cross threading and a removable banjo clip allows the installer to switch the handle orientation. The 1/2-in angle stop valve comes with an adapter and can be converted to either 1/2-in IPS or 3/8-in compression plumbing systems.



### Contact Information:

Parker Hannifin Corporation  
**Fluid System Connectors Division**  
300 Parker Dr.  
Otsego, MI 49078

phone 269-692-6555  
fax 269-694-4614

[water.parker.com](http://water.parker.com)

### Product Features:

- Full flow design reduces pressure drop across the valve
- Valve body rotates for easy tube routing
- Removable clip for changing the handle orientation
- 3/8" female compression x 1/2" male NPSM adapter for connecting to 1/2" IPS lines



ENGINEERING YOUR SUCCESS.

# LIQUIfit™ VAS

## Angled Stop Valve

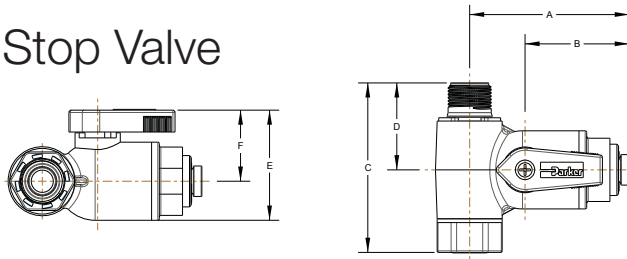

Part No.	Tube O.D.	Male Thread	Female Thread	A	B	C	D	E	F
LFPP4VAS6	1/4	3/8 Compression	3/8 Compression	1.79	1.07	2.17	1.11	1.41	.91
LFPP6VAS6	3/8	3/8 Compression	3/8 Compression	2.02	1.31	2.17	1.11	1.41	.91

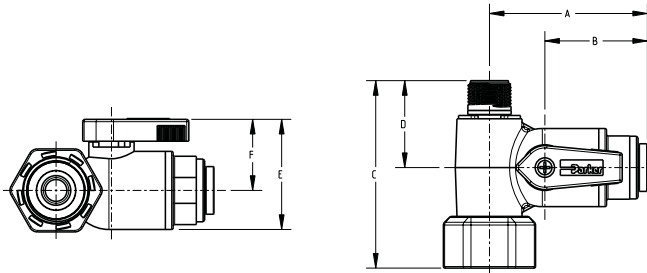

Part No.	Tube O.D.	Male Thread	Female Thread	A	B	C	D	E	F
LFPP4VAS8*	1/4	3/8 Compression	1/2 NPSM	1.79	1.07	2.40	1.11	1.41	.91
LFPP6VAS8*	3/8	3/8 Compression	1/2 NPSM	2.02	1.31	2.40	1.11	1.41	.91

\* Part number includes adapter U8TVA6

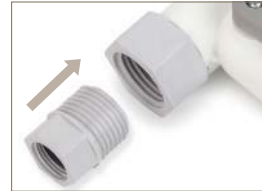
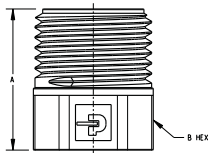

### Banjo Bolt Adapter

Part No.	A	B	Thru Dia.	Male Thread	Female Thread
U8VTA6	.98	.75	.28	1/2 NPSM	3/8 Compression

1. Shut off water supply at brass/chrome supply valve.  
Disconnect riser from brass/chrome supply valve.  
Ensure that the sealing gasket is fully seated into the Angle Stop Valve female thread.

2. Install Angle Stop Adapter Valve on supply valve.  
Connect the riser to the Angle Stop Adapter Valve.  
Tighten valve and riser 1/2 turn past finger tight

3. Fully insert tubing into the side of the valve.  
Open valves and check for leaks.

**Do not use thread sealant. Do not over tighten.**

