

Aluminum 60 Series

ISO 7241, Series B Interface Quick Couplings



Light Weight, Industrial Interchange with Color Coding Options.

Parker's Aluminum 60 Series are general purpose quick couplings, that can be used across a spectrum of low pressure fluid applications.

These double shut-off couplings are suitable for both pressure and vacuum applications. A variety of port ends and seal options provide a wide range of versatility. 60 Series couplers and nipples are compliant with ISO 7241-1, Series B and will interchange with other couplings meeting that industry standard.

Color coding options can provide a quick and easy way to identify mating lines and help to prevent cross connection.



Contact:

Parker Hannifin Corporation
Quick Coupling Division
8145 Lewis Road
Minneapolis, MN 55427

phone 763 544 7781
fax 763 544 3418
QCD_sales@parker.com

www.parker.com/quickcouplings



Aluminum 60 Series Features:

- Lightweight, corrosion-resistant aluminum construction (up to 60% lighter than comparable steel couplings)
- Modular two-piece design allows for a wide variety of end configurations
- Hard coat, anodized finish provides a surface that is resistant to scratches and wear
- Positively stopped valves prevent flow checking
- Wide range of seal options
- Dual interface seal design protects against leaks
- Crimped valve seals prevent seal wash out
- Color coding options visually identify fluid lines to help prevent cross connection

ENGINEERING YOUR SUCCESS.

Aluminum 60 Series Quick Couplings

Specifications:

Size	Rated Operating Pressure		Rated Flow		Pressure Drop @ Rated Flow	
	Inch	Bar	PSI	L/min	GPM	Bar
1/4	69	1000	12	3	0.74	10.8
3/8	69	1000	23	6	0.94	13.6
1/2	69	1000	45	12	0.89	12.9
3/4	35	500	66	28	1.01	14.6
1	35	500	189	50	1.23	17.9

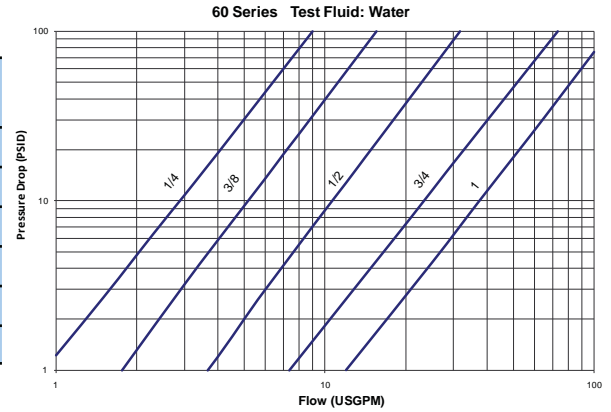

Part Numbers and Dimensions:

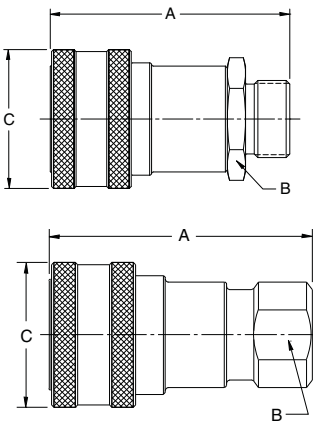

Body Size	Coupler Part Number	Thread Size	Overall Length	Hex Size	Largest Dia (in)	Wt (LB) P/Piece
			A	B	C	
1/4	AH2-60-4MS	9/16-18 ORFS (male Seal-Lok)	2.28	1.00	1.14	0.15
1/4	AH2-60-T6	9/16-18 ORB (female)	2.41	0.81	1.14	0.10
3/8	AH3-60-6MS	11/16-16 ORFS (male Seal-Lok)	2.61	1.19	1.40	0.21
3/8	AH3-60-T8	3/4-16 ORB (female)	2.75	1.00	1.40	0.18
1/2	AH4-60-8MS	13/16-16 ORFS (male Seal-Lok)	2.95	1.50	1.77	0.34
1/2	AH4-60-T10	7/8-14 ORB (female)	3.05	1.12	1.77	0.30
3/4	AH6-60-12MS	1-3/16 - 12 ORFS (male Seal-Lok)	3.55	1.63	2.14	0.63
3/4	AH6-60-T12	1-1/16 - 12 ORB (female)	3.67	1.31	2.14	0.50
1	AH8-60-16MS	1-7/16 - 12 ORFS (male Seal-Lok)	4.13	2.00	2.52	0.92
1	AH8-60-T16	1-5/16 - 12 ORB (female)	4.18	1.62	2.52	0.60

Contact the Quick Coupling Division for other port configuration options.

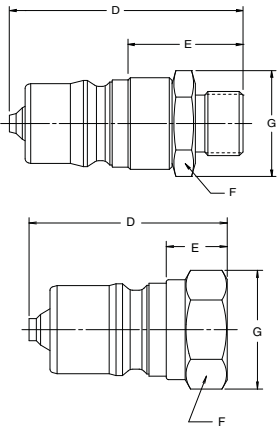

Body Size (in)	Nipple Part Number	Thread Size	Overall Length	Exposed Length*	Hex Size	Largest Dia (in)	Wt (LB) P/Piece
			D	E	F	G	Piece
1/4	AH2-63-4MS	9/16-18 ORFS (male Seal-Lok)	2.22	1.18	0.75	0.87	0.87
1/4	AH2-63-T6	9/16-18 ORB (female)	1.69	0.70	0.88	1.00	1.00
3/8	AH3-63-6MS	11/16-16 ORFS (male Seal-Lok)	2.52	1.38	1.00	1.15	1.15
3/8	AH3-63-T8	3/4-16 ORB (female)	1.92	0.80	1.00	1.15	1.15
1/2	AH4-63-8MS	13/16-16 ORFS (male Seal-Lok)	2.65	1.37	1.19	1.37	1.37
1/2	AH4-63-T10	7/8-14 ORB (female)	2.12	0.87	1.19	1.37	1.37
3/4	AH6-63-12MS	1-3/16 - 12 ORFS (male Seal-Lok)	3.13	1.46	1.38	1.58	1.58
3/4	AH6-63-T12	1-1/16 - 12 ORB (female)	2.54	0.90	1.38	1.58	1.58
1	AH8-63-16MS	1-7/16 - 12 ORFS (male Seal-Lok)	3.44	1.53	1.63	1.88	1.88
1	AH8-63-T16	1-5/16 - 12 ORB (female)	2.91	0.99	1.63	1.88	1.88

Contact the Quick Coupling Division for other port configuration options.

* This dimension represents the portion that is exposed when the nipple is connected with the mating Parker coupler.

Part Number Code:

AH X - 6X X - X X - XX

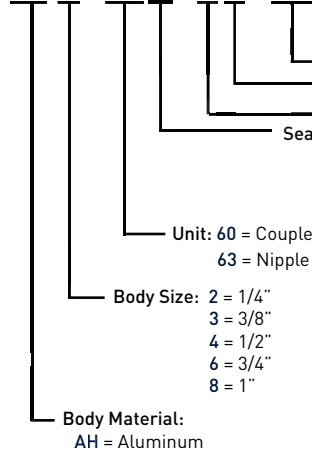

Seal Code: Blank = Nitrile
 N1 = Peroxide Cured
 N2 = HNBR
 N3 = FDA Approved
 N4 = -65 to 275 F
 Z = Neoprene
 D = Silicone
 W = Ethylene Propylene (EPDM)
 Y = Fluorocarbon
 G = GFLT (Fuel Fluorocarbon)
 L = Fluorosilicone
 P = Perfluoroelastomer
 P1 = FF-500 (steam & chemical)
 P2 = FF-200 (high temperature)
 P3 = FF-350 (high purity)
 U = Urethane

Fitting Style:

Blank = Female Pipe
 TX = Female ORB (X = size)
 BSPP = Female BSPP, DIN 3852-2, "X", ISO 1179-1
 CA = A-Lok Tube Fitting
 FM = Female Metric ORB, ISO 6149-1
 FS = Female ORFS, Seal-Lok
 HB = Hose Barb
 MF = Male 37 Flare
 MM = Male Metric ORB, ISO 6149-2
 MO = Male ORB, SAE
 MP = Male Pipe
 MS = Male ORFS, Seal-Lok
 PL = Push-Lok Hose Barb

Standard Options:

Blank = No Options
 SL = Sleeve-Lok
 W/O = No Valve
 VA = Valve Actuator
 Color options:
 BU = Blue
 GN = Green
 RD = Red
 YW = Yellow

Add B prefix for bulkhead style without nut
 Add H prefix for bulkhead style with nut