

Garden Hose Fittings

Advantages

All fitting pipe threads are made to Dryseal standards. Connectors, unions, nuts and extruded elbows and tees are machined from CA 360 and CA 345 brass.

Temperature and Working Pressure Ranges

From +35°F. to +100°F. at 75 PSI maximum or the recommended working pressure of garden hose. (not to exceed 150 PSI.)

Note: 90GH is intended for use with 97HC hose clamp or crimped ferrule.

Note: All female connector ends should have a rubber washer (901GH-12) inserted prior to usage.

Order

By part number and name.

Nomenclature

Part numbers are constructed from symbols that identify the style and size of the fitting. The first series of numbers and letters identifies the style and type fitting. The second series of numbers describes the size.

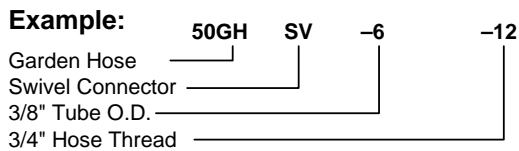

Sizes

Pipe sizes are determined by the number of sixteenths of an inch in the pipe size.

Pricing

Only items priced in current supplementary price list PL3501 are carried in stock. Price and delivery for non-stock items furnished on request for specified quantity.

Garden Hose Fittings

Swivel connector SAE flare to female hose thread 50GHSV

PART NO.	TUBE SIZE	HOSE THREAD	L	M	FLOW DIA.D
50GHSV-6-12	3/8	3/4	1.25	1.15	.297
50GHSV-8-12	1/2	3/4	1.34	1.15	.406

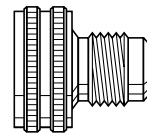
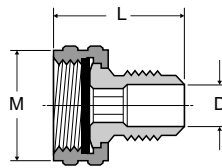

Hose barb to male hose thread 53GH, 54GH & 55GH

PART NO.	I.D. HOSE SIZE	HOSE THREAD	C HEX	L	FLOW DIA.D
53GH-8-12	1/2	3/4	1-1/16	1.88	.375
54GH-10-12	5/8	3/4	1-1/16	1.88	.500
55GH-12-12	3/4	3/4	1-1/16	1.88	.625

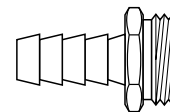
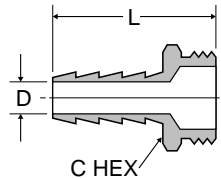

Male hose to male pipe 69GH, 70GH, 71GH

PART NO.	HOSE THREAD	PIPE THREAD	C HEX	L	FLOW DIA.D
69GH-12-6	3/4	3/8	1-1/16	1.25	.406
70GH-12-8	3/4	1/2	1-1/16	1.39	.531
71GH-12-12	3/4	3/4	1-1/16	1.41	.750

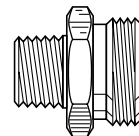
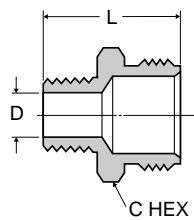

Male hose to male hose 75GH

PART NO.	HOSE THREAD	C HEX	L	FLOW DIA.D
75GH-12	3/4	1-1/16	1.25	.750

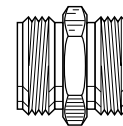
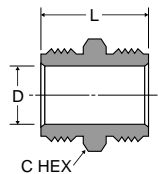

Male hose to female pipe 78GH, 79GH, 80GH & 81GH

PART NO.	HOSE THREAD	PIPE THREAD	C HEX	L	FLOW DIA.D
78GH-12-4	3/4	1/4	1-1/16	.75	.422
79GH-12-6	3/4	3/8	1-1/16	.75	.562
80GH-12-8	3/4	1/2	1-1/16	.75	.687
81GH-12-12	3/4	3/4	1-3/16	1.28	.719

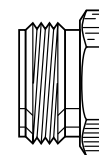
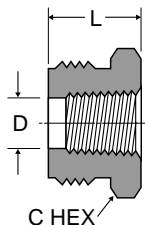

Female hose to male pipe 82GH & 83GH

PART NO.	HOSE THREAD	PIPE THREAD	C HEX	L	FLOW DIA.D
82GH-12-8	3/4	1/2	1-3/16	1.20	.562
83GH-12-12	3/4	3/4	1-3/16	1.22	.750

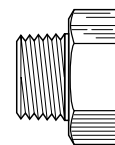
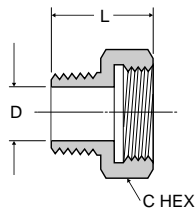

Special filter adapter 84GH

PART NO.	HOSE THREAD	PIPE THREAD	C HEX	L	FLOW DIA.D
84GH-8-8	1/2	1/2	15/16	1.53	.530

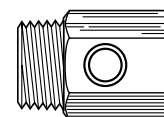
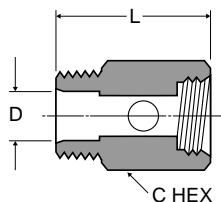

Swivel connector female garden hose to male pipe 88GH

PART NO.	HOSE THREAD	PIPE THREAD	L	M	FLOW DIA.D
88GH-12-4	3/4	1/4	1.60	1.15	.312
88GH-12-6	3/4	3/8	1.54	1.15	.406

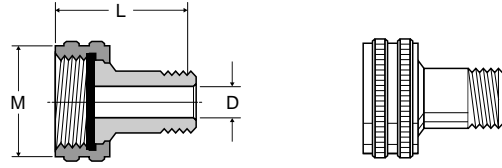

Swivel connector female garden hose to hose barb 90GH

PART NO.	HOSE THREAD	I.D. HOSE SIZE	L	M	FLOW DIA.D
90GH-12-3	3/4	3/16	1.29	1.15	.125
90GH-12-4	3/4	1/4	1.21	1.15	.187
90GH-12-6	3/4	3/8	1.21	1.15	.281
90GH-12-8	3/4	1/2	1.21	1.15	.375
90GH-12-10	3/4	5/8	1.93	1.19	.500
90GH-12-12	3/4	3/4	1.93	1.19	.625

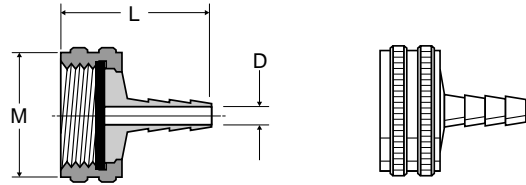

Knurled hose nut 94GH

PART NO.	HOSE THREAD	L	M	FLOW DIA.D
94GH-12	3/4	.57	1.15	.808

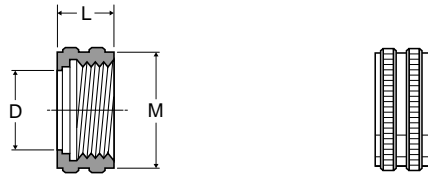

Hose nut reducer 95GH

PART NO.	HOSE THREAD	PIPE THREAD	C HEX	L
95GH-12-2	3/4	1/8	1-1/8	.63



Hose cap nut 96GH

PART NO.	HOSE THREAD	L	M
96GH-12	3/4	.50	1.15

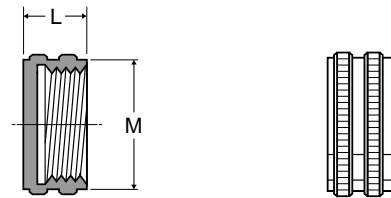

Female hose to female pipe 98GH & 99GH

PART NO.	HOSE THREAD	PIPE THREAD	C HEX	L	M	FLOW DIA.D
98GH-12-8	3/4	1/2	1-3/16	1.14	1.01	.687
99GH-12-12	3/4	3/4	1-3/16	1.25	1.17	.750

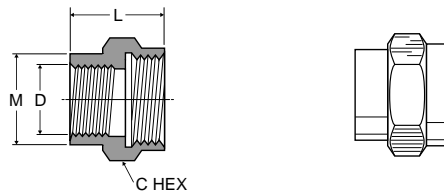

Swivel connector female hose to female pipe 98GHSV & 99GHSV

PART NO.	HOSE THREAD	PIPE THREAD	C HEX	L	M	FLOW DIA.D
98GHSV-12-8	3/4	1/2	1	1.27	1.21	.687
99GHSV-12-12	3/4	3/4	1-3/16	1.34	1.21	.687

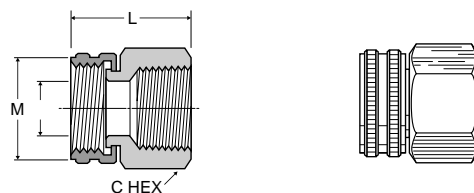

Garden Hose Fittings

Swivel nut connector 101GHSV

PART NO.	HOSE THREAD	L	M	FLOW DIA.D
101GHSV-12	3/4	1.25	1.15	.625

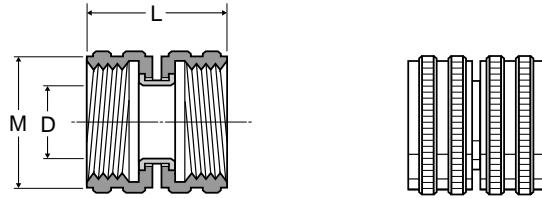

Rubber garden hose coupling washer 901GH

PART NO.	HOSE THREAD
901GH-12	3/4

NOTE: All female connector ends should have this rubber washer installed prior to usage.



Hydraulic Quick Couplings/High Flow Couplings

Applications

Parker Water Service Couplings are used anywhere water hoses are connected and disconnected frequently. They are used on a wide variety of applications including garden hoses, wash down systems, and mobile water tank lines. The unvalved design permits maximum flow with minimum pressure drop.

Features

- Brass and stainless steel construction for heavy duty service.
- Durable 4-ball locking mechanism for secure connections.
- Quality, temperature-resistant nitrile seals for a leak-free service life.

Specifications

Body Size	3/4"
Rated Pressure (PSI)	200
Rated Flow (GPM)	28
Temperature Range (std seals)	-40°F to +250°F

High flow coupler 1163-60-BPD

PART NO.	BODY SIZE	THREAD SIZE NH	A	C
1163-60-BPD	3/4	3/4-11 1/2	1.12	1.21

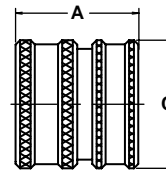

High flow nipple 1163-61-BPD

PART NO.	BODY SIZE	THREAD SIZE NH	D	E
1163-61-BPD	3/4	3/4-11 1/2	1.25	.50

